

ITEM NO.	DESCRIPTION	MAN.P/NO.	D&S P/NO.
1	Discharge, 12-25 Stages	0050100RP	DS2-1A
1	Discharge, 33-60 Stages	0050100L0RP	DS2-1B
2	Valve Casing	0050200	DS2-2
3	Valve guide	0050300	NSI
4	Valve cone	0050400	NSI
12	Diffuser - 12/18/25 Stages	0051200	DS2-12A
12	Diffuser - 33-60 Stages	0051200L0	DS2-12B
18	Impeller	0181800	DS3-18
24	Stop Ring	0052400	DS2-24
26	Spacing washer for stop ring	0052600	DS2-26
34	Strainer - 12-25 Stages	0183400	DS3-34A
34	Strainer - 33-60 Stages	0183400L0	DS3-34B
36	Suction Interconnector - 12-25	0053600	DS2-36A
36	Suction Interconnector -33-60	0403600	DS2-36B
40	Pump shaft/Coupling - 12 Stage	005370012	DS3-40A
40	Pump shaft/Coupling -18 Stage	005370018	DS3-40B
40	Pump shaft/Coupling - 25 Stage	005370025	DS3-40C
40	Pump shaft/Coupling - 33 Stage	005370033	DS2-40D
40	Pump shaft/Coupling - 45Stage	005370045	DS3-40D
40	Pump shaft/Coupling - 60 Stage	005370060	DS3-40F
NSI - Non stock item available on special order only			

ITEM NO.	DESCRIPTION	MAN.P/NO.	D&S P/NO.
42	Shaft sleeve	0054200	DS2-42A
47	Strap - 12 Stage	005470012	NSI
47	Strap - 18 Stage	005470018	NSI
47	Strap - 25 Stage	005470025	NSI
47	Strap - 33 Stage	005470033	DS2-47A
47	Strap - 45 Stage	005470045	NSI
47	Strap - 60 Stage	005470060	NSI
52	Cable guard - 12 Stage	005520012	NSI
52	Cable guard - 18 Stage	005520018	NSI
52	Cable guard - 25 Stage	005520025	NSI
52	Cable guard - 33 Stage	005520033	NSI
52	Cable guard - 45 Stage	005520045	NSI
52	Cable guard - 65 Stage	005520060	NSI
86	Valve seat	0058600	DS2-86
87	Neck ring	0058700	DS2-87
88	Screw M5	J04M08	NSI
89	Bearing	0058900	DS2-89
90	Nut M8	J02M0830	NSI
91	Washer	0059100	NSI
93	Lock nut	0059300	NSI
NSI - Non stock item available on special order only			

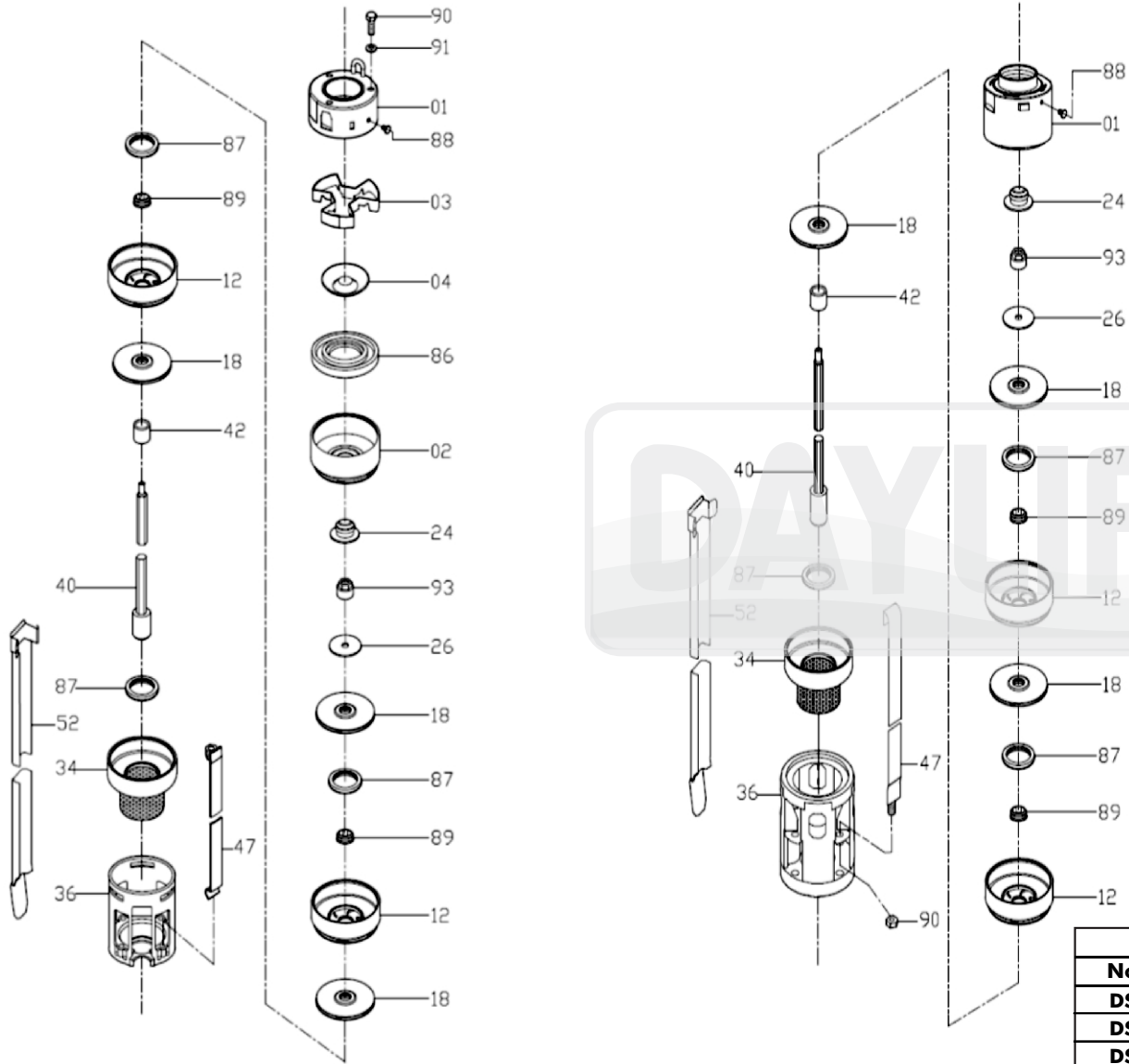

REPAIR KIT DS2/3/5				
No.	Description	5STG	15STG	30STG
DS2-86	VALVE SEAT DS2/3/5	1	1	1
DS2-87	NECK RING DS2/3/5	5	15	30
DS2-89	BEARING DS2/3/5	5	15	30
DS2-24	STOP RING	1	1	1
DS2-26	SPACING WASHER FOR STOP RING	1	1	1