

ITEM NO.	DESCRIPTION	MAN.P/NO.	D&S P/NO.
1	Discharge	0800100RP	DS17-1A
4	Valve cone	0800400	NSI
11	Top Diffuser	0901100	DS17-11A
12	Diffuser	0901200	DS17-12A
18	Impeller	0901800	DS17-18A
19	Ring of Impeller	0901900	NSI
21	Split Cone	0902100	DS17-21
22	Split cone nut	0902200	DS17-22
26	Stop ring washer	0902600	DS17-26
32	Neck ring retainer	0903200	DS17-32
34	Strainer	0803400	DS17-34
36	Suct. interconnector-7-13 stages	0803600A0	DS17-36A
36	Suct. interconnector - 17-27 stages	0803600	DS17-36B
40	Shaft - 7 stage	0904000A007	DS17-40A
40	Shaft- 10 stage	0904000A010	DS17-40A
40	Shaft- 13 stage	0904000A013	DS17-40B
37	Shaft- 17stage	090370017	DS17-37A
37	Shaft- 20 stage	090370020	DS17-37D
37	Shaft- 24 stage	090370024	DS17-37C
37	Shaft-27 stage	090370027	DS17-37C
NSI - Non stock item available on special order only			

ITEM NO.	DESCRIPTION	MAN.P/NO.	D&S P/NO.
44	Shaft coupling 6"	0904400	DS17-44
47	Strap - 7 stage	0904700A007	NSI
47	Strap - 10 stage	0904700A010	NSI
47	Strap - 13 stage	0904700A013	NSI
47	Strap - 17stage	090470017	NSI
47	Strap - 20 stage	090470020	NSI
47	Strap - 24 stage	090470024	NSI
47	Strap - 27 stage	090470027	NSI
52	Cable Guard - 7 stage	0905200A007	NSI
52	Cable Guard - 10 stage	0905200A010	NSI
52	Cable Guard - 13 stage	0905200A013	NSI
52	Cable Guard - 17 stage	090520017	NSI
52	Cable Guard - 20 stage	090520020	NSI
52	Cable Guard - 24 stage	090520024	NSI
52	Cable Guard - 27 stage	090520027	NSI
86	Valve Seat	0808600	NSI
87	Neck Ring	0908700	DS17-87
88	Nut	J01M12	NSI
89	Bearing	0908900	DS17-89
NSI - Non stock item available on special order only			

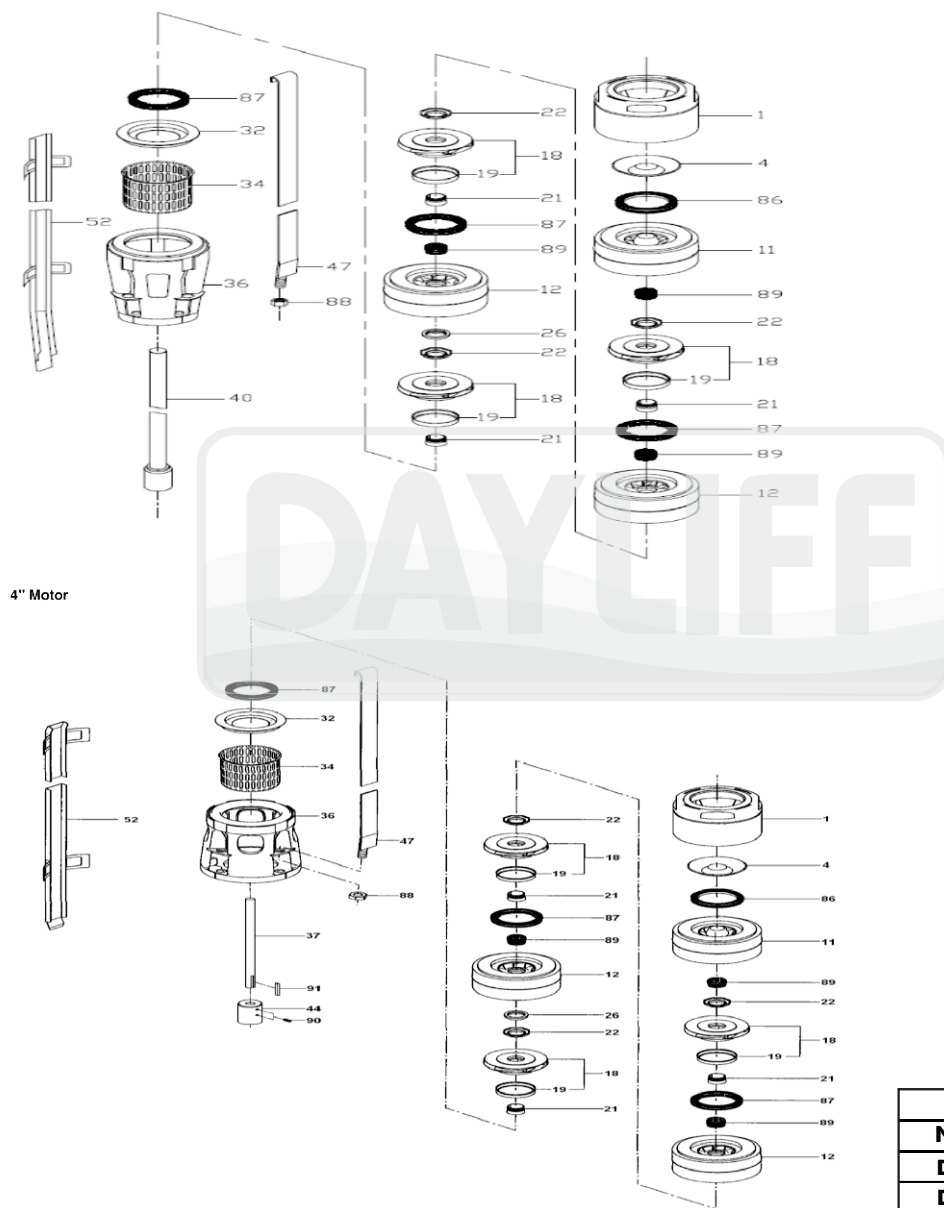

REPAIR KIT DS17			
No.	Description	5STG	10STG
DS17-89	BEARING DS17	5	10
DS17-87	NECK RING DS17	5	10